

**CAUTION**

If draining of the heater is necessary, open the temperature and pressure valve or a hot water tap to prevent vacuum buildup in the tank and piping.

**WARNING**

Risk of scald injury increases as you increase water temperature.

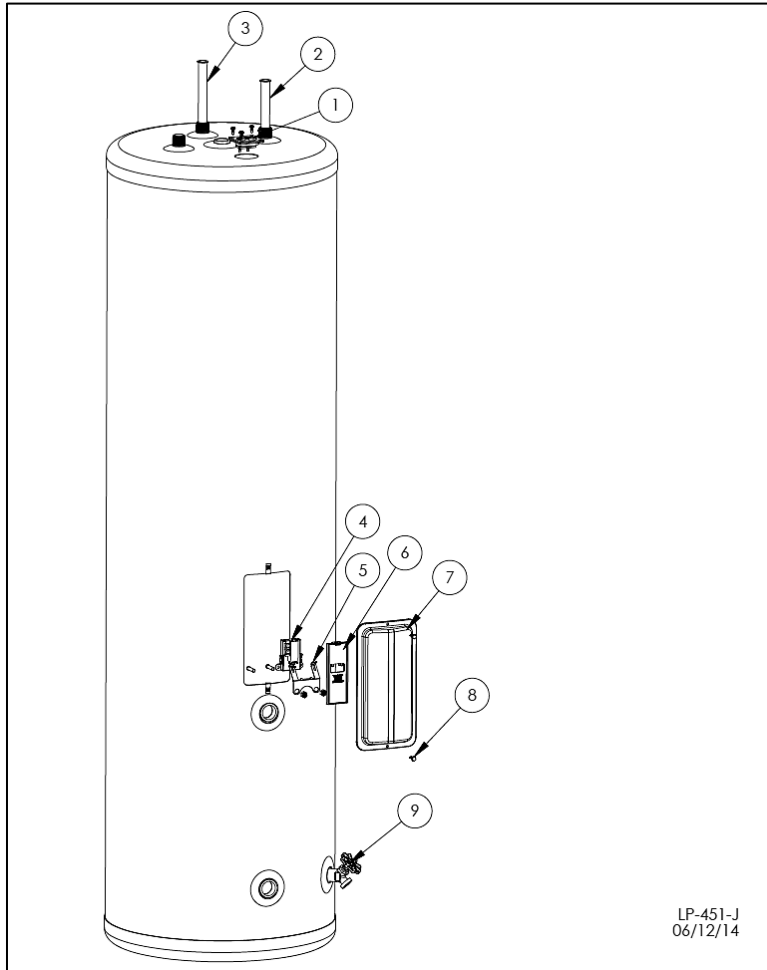

Figure 10 – Replacement Parts

ITEM #	PART #	DESCRIPTION
1	6070P-035	TERMINAL BLOCK W/ SCREWS
2	6070P-038	DIP TUBE COLD INLET – SSP-30
	6070P-039	DIP TUBE COLD INLET – SSP-40
	7700P-062	DIP TUBE COLD INLET – SSP-50
	6070P-041	DIP TUBE COLD INLET – SSP-60
	6070P-042	DIP TUBE COLD INLET – SSP-80 AND SSP-115
3	6070P-044	DIP TUBE AUXILIARY INLET – SSP-30
	6070P-045	DIP TUBE AUXILIARY INLET – SSP-40 AND SSP-60
	6070P-046	DIP TUBE AUXILIARY INLET – SSP-50
	6070P-047	DIP TUBE AUXILIARY INLET – SSP-80
	6070P-048	DIP TUBE AUXILIARY INLET – SSP-115
4	TD1012	THERMOSTAT
5	6060P-633	MOUNTING CLIP
6	6060P-634	PROTECTIVE COVER
7	H3000	ELECTRIC ACCESS PANEL
8	6075P-006	SCREWS (#8 SELF-THREADING)
9	6070P-009	COMBINATION DRAIN VALVE

Table 4 – Replacement Parts List