



**Advanced Heating  
& Hot Water Systems**

# Phoenix<sup>®</sup> LIGHT DUTY

Highly Efficient Stainless Steel  
Gas-Fired Water Heater



**76,000 Btuh  
50, 60 & 80  
Nominal  
Gallon Tanks**

**Up to 97% Thermal Efficiency**

**Up to .90 UEF**

**Modulating Combustion System**

**316L Stainless Steel Tank**

**Multiple Venting Options**

- 2" PVC, CPVC or ULC S636 pipe
- Combined vent length of 150 ft



## **Solar Version**

Solar Tank  
with Gas Fired  
Back-Up



# Phoenix LD

## A CLOSER LOOK

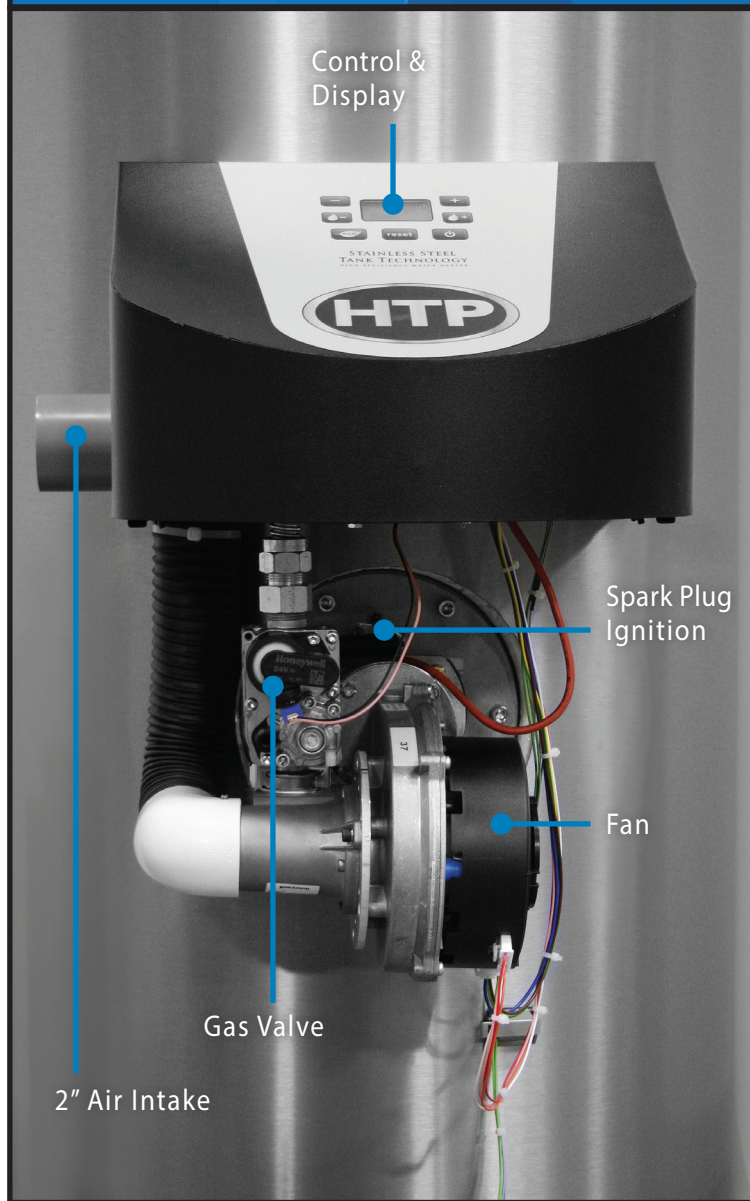

### NO Anode Rods Needed!

All coated tanks require anodes to delay the inevitable corrosion and tank failure. The Phoenix Light Duty stainless steel tank will outlast any coated steel tank in the market!

## High Efficiency Stainless Steel Gas-Fired Water Heater

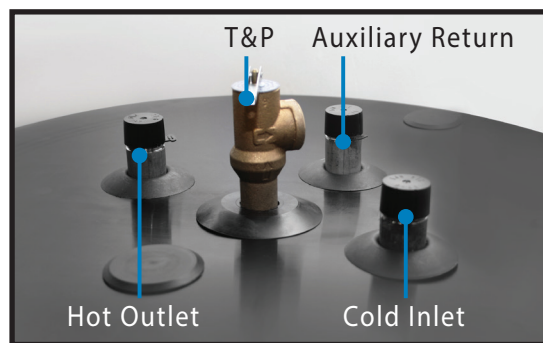

### Heat Exchanger

Cupronickel spiral design that expands and contracts rapidly with the change in temperature resisting scale build-up.

-Durable Construction

-High Performance

-Excellent Heat Transfer Capabilities

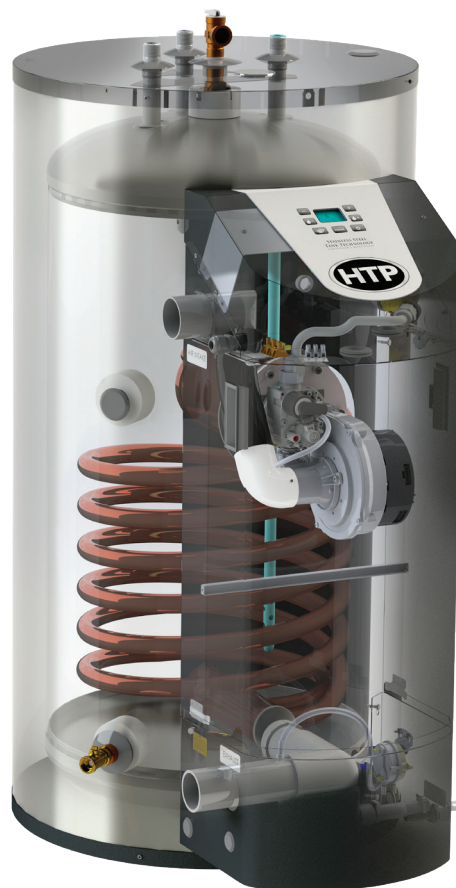



# CONTROL & DISPLAY



## Functions

1. Menu Navigation Down
2. Menu Navigation Up
3. Decreases the DHW Setpoint
4. Increases the DHW Setpoint
5. **ECO Mode:** PROVIDES REAL ENERGY SAVINGS, WHEN LESS HOT WATER IS NEEDED
6. Reset
7. Off/DHW Mode Enable

# FEATURES

## Modulating Combustion System

- 3:1 turndown ratio - 25,000 to 76,000 Btuh
- Ultra Low NOx compliant

## Superior 316L Stainless Steel Tank Construction

- 3 tank sizes: 50, 60, & 80 nominal gallons
- Laser welded precision, lightweight tank
- No anode rods needed

## Highly Efficient Combustion Heat Exchanger

- The Phoenix Light Duty uses the latest, patented technology and is covered by U.S. Patent No. 10,024,57, it's cupronickel heat exchanger design boasts excellent heat transfer properties and resists corrosion
- High grade stainless steel burner

## Venting

- 2" PVC, CPVC or ULC S636 pipe
- Combined vent length of 150 feet
- Two pipe / single pipe, balanced or unbalanced venting system

## The Phoenix LD performs better than tankless

- Avoid inconsistent water fluctuations
- No minimum flow rates needed to provide hot water
- Deliver hot water to multiple outlets and large volume showers faster

## Advanced Electronic Control

- Easy to read LCD (icon and text) display

## Highly Efficient Operation

- Up to 97% Thermal Efficiency
- Up to .90 Uniform Energy Factor

## Ease of Installation

- Top ports on inlet and outlet
- Top connect auxiliary port for recirculation line or **AIR HANDLER** piping, increases overall efficiency

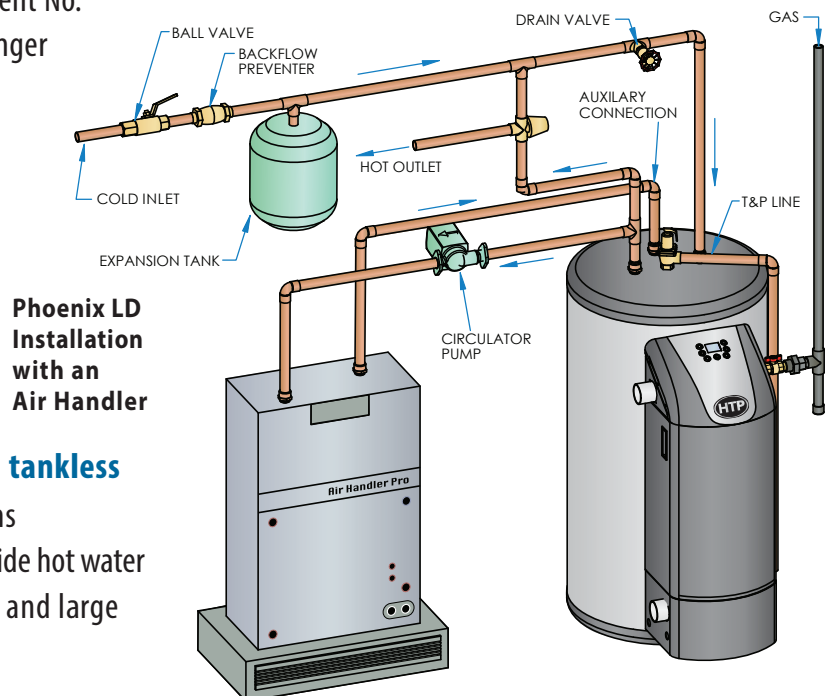

# PhoenixLD Specifications

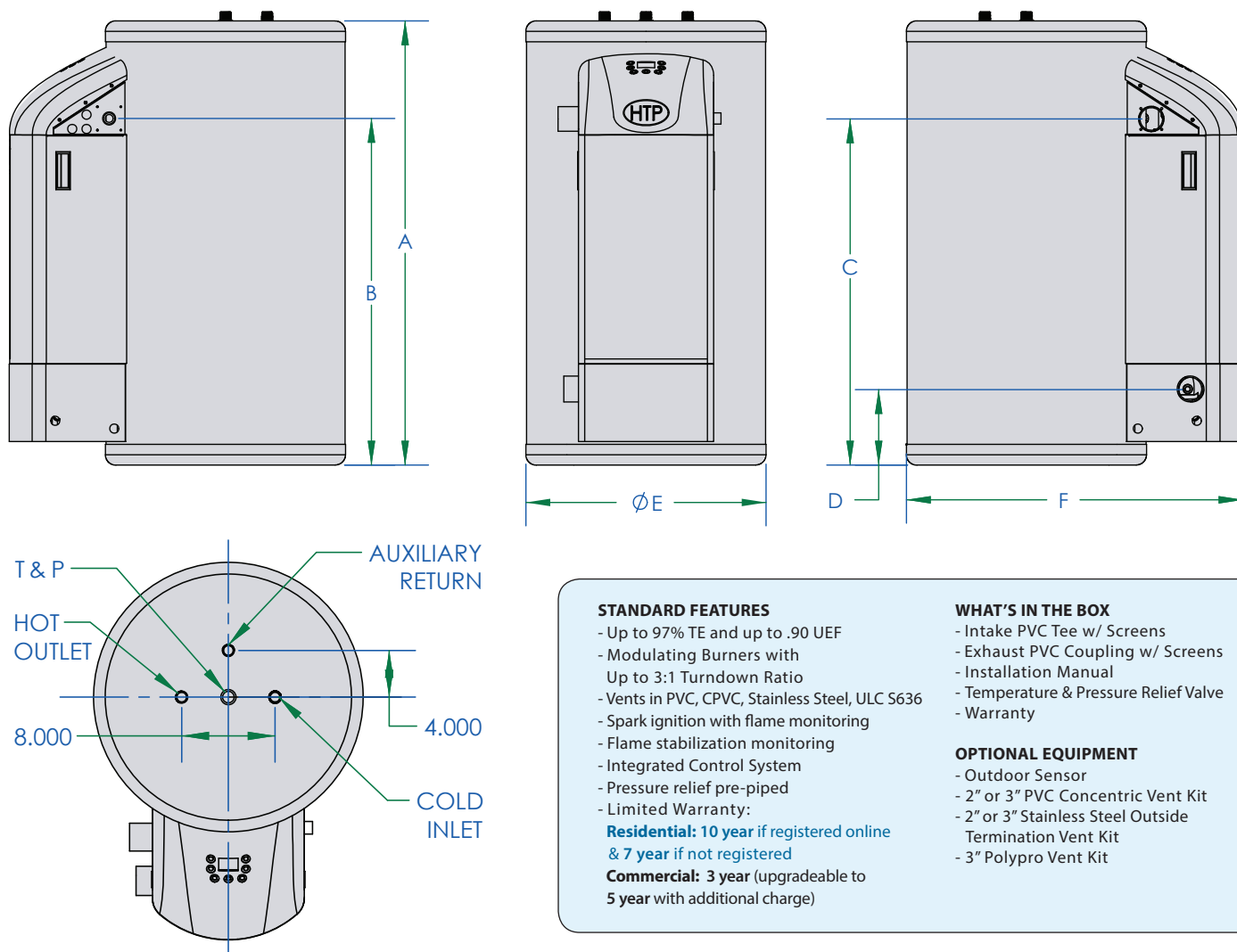

MODEL	A	B	C	D	E	F	Nominal Storage Capacity	Vent Size	Gas Line	Inlet/Outlet Size	Relief Valve	Aux Conn.
PH76-50	44.75"	33"	33"	6.75"	23"	32.5"	50 GAL.	2"	1/2"	3/4" NPT	3/4" FNPT	3/4" NPT
PH76-60	52.625"	33"	33"	6.75"	23"	32.5"	60 GAL.					
PH76-80	69"	33"	33"	6.75"	23"	32.5"	80 GAL.					

MODEL	Btuh	DOE Rated Storage Volume	UEF	Recovery Efficiency	First Hour Rating	First Hour Rating Bin	Thermal Efficiency	Recovery GPH At 90° F Rise	Max. Temp Limit
PH76-50	25,000 - 76,000	48 GAL.	.90	96%	154 GAL.	High	97%	98	160°F
PH76-60	25,000 - 76,000	58 GAL.	.88	97%	157 GAL.	High	97%		
PH76-80	25,000 - 76,000	77 GAL.	.87	94%	206 GAL.	High	95%		
PH76-80S*	25,000 - 76,000	77 GAL.	N/A	94%	206 GAL.	High	95 %	107	

\* Solar

In accordance with our company policy of ongoing product improvement, HTP Inc. reserves the right to make changes without prior notice.

MKTLIT-53 - 07/2019 © HTP

272 Duchaine Blvd, New Bedford, MA 02745 • 1-800-323-9651 • [www.htproducts.com](http://www.htproducts.com)